

# Quick Start Guide

## Network Security Platform

SAF51003I

### Package Contents



1. Network Security Platform SAF51003I
2. Four adhesive foot pads
3. AC/DC Power Adapter



4. Power Cord—either Japan, US, Continental Europe or UK
5. Console Cable—RJ-45 to DB-9



**Note:** The device is an open platform with Ubuntu Linux pre-installed, but no application software.

### 1 Desktop Mount the Device

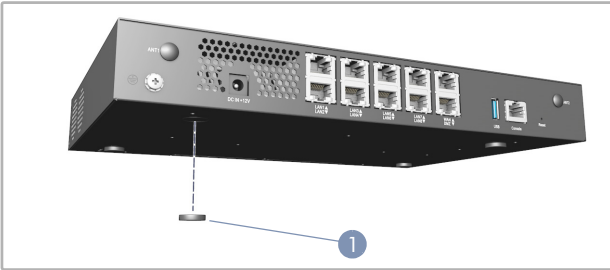

1. Attach the four rubber foot pads to the base of the device, and then place it on a desktop or shelf.

### 2 Ground the Device

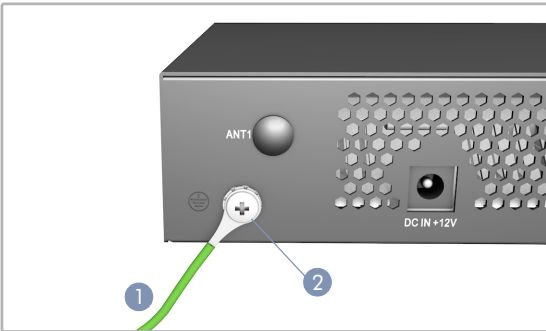

1. Ensure the device is properly grounded in compliance with ETSI ETS 300 253. Verify that there is a good electrical connection to the grounding point (no paint or isolating surface treatment).
2. Attach the grounding wire (#14 AWG) to the grounding point on the device rear panel. Then connect the other end of the wire to ground.

### 3 Connect Power

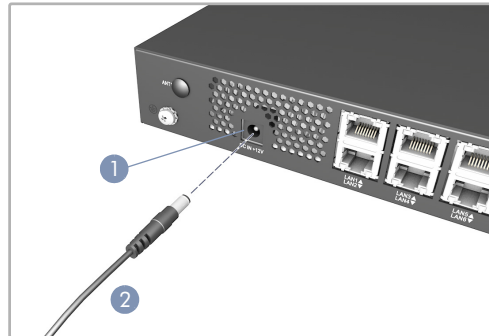

1. Connect the AC/DC power adapter to the DC jack on the device.
2. Connect the AC/DC power adapter to an external AC power source.

### 4 Verify Device is Powered On

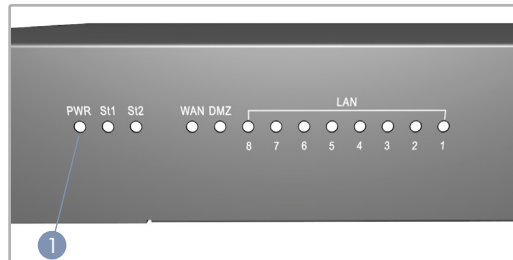

1. Verify the device is powered on by checking the PWR LED. When operating normally, the PWR LED should be on green.

### 5 Connect Network Cables

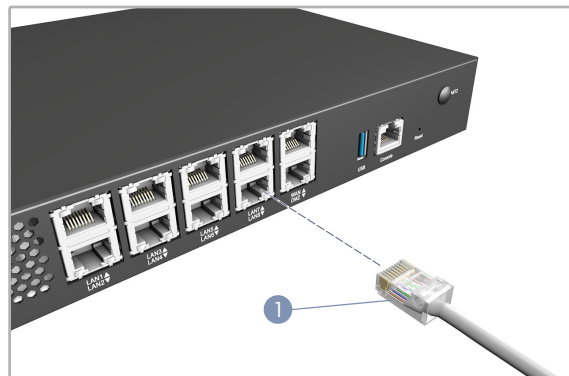

1. For the RJ-45 ports, connect 100-ohm Category 5, 5e or better twisted-pair cable.

2. As connections are made, check the port status LEDs to be sure the links are valid.
  - Green — 1 Gbps mode
  - Amber — 10/100 Mbps mode

## 6 Connect to the Console Port

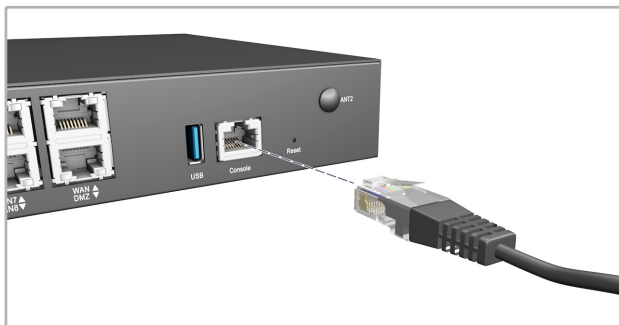

1. Connect a PC to the serial console port using the included console cable.
2. Configure the PC's serial port as follows:
  - 115200 bps
  - 8 characters
  - No parity
  - One stop bit
  - 8 data bits
  - No flow control
3. Log in to the Ubuntu system using the default settings:
  - Username "root"
  - Password "accton"

**i** **Note:** Device drivers can be downloaded from: [www.accton-nfv.com/support/open-download](http://www.accton-nfv.com/support/open-download)

## SAF51003I Specifications

Form Factor	Compact desktop
Dimensions (W x D x H):	300 x 200 x 38.5 mm (11.81 x 7.87 x 1.52 inches)
Weight	1.58 kg (3.48 lb)
CPU	SoC, Intel® Atom™ Processor for Communications C3000 Series (FCBGA, 14nm), supports 2-4 cores 2.2 GHz (turbo 2.4 GHz)
Memory	Sockets: 2x 260pin DDR4 SODIMM slot Type: DDR4 1866/2133/2400 MHz ECC (64GB Max)
Local Storage	1 x 2.5" 500GB HDD 1 x M.2 SATAIII SSD, support 2242/2280 type
I/O Interfaces	1 x USB 3.0 Type A 1 x RJ-45 serial console 1 x hardware reset button
Network Interfaces	1 x RJ-45 GbE for DMZ 1 x RJ-45 port for WAN 8 x RJ-45 GbE for LAN
Expansion	Type: 1 x Mini PCIe Signal: PCIe x1 and USB 2.0
Accelerator	Advanced Technologies: Intel® VT-x, Intel® VT-d, SR-IOV, VMDq, QuickAssist, PECC over SMBUS, eSPI, NC-SI, Core and Memory RAPL, Memory OLTT and CLTT
Power Adapter	Input: AC 110 to 240 @ 50/60 Hz Output: 12 VDC, 5.0 A, 60 W
System Cooling	2x PWM fans, supports smart-fan
Temperature	Operating: 0 °C to 40 °C (32 °F to 104 °F) Storage: -20 °C to 70 °C (-4 °F to 158 °F)
Humidity	Operating: 20% to 90% (non-condensing) Storage: 5% to 90% (non-condensing)
Compliances	CE FCC RoHS 2.0

# 快速入门指南

## 网络安全平台

SAF51003I



1. 网络安全平台 SAF51003I
2. 四个粘合型支脚垫
3. 交流 / 直流电源适配器

4. 电源线 — 日式、美式、欧陆式或英式
5. 控制台线 — RJ-45 转 DB-9



注意：本设备预装 Ubuntu Linux 开放平台，但未安装应用程序软件。

### 1 设备桌面安装

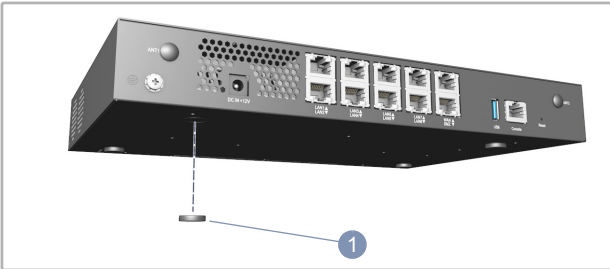

1. 将四个橡胶支脚垫安装到设备底座，然后将其放到桌台或架子上。

### 2 将设备接地

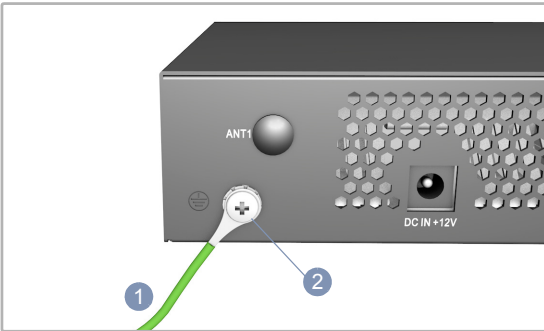

1. 确保设备已按照 ETSI ETS 300 253 规范正确接地。验证到接地点的电力连接良好（未涂漆或绝缘表面处理）。
2. 将接地线（#14 AWG）连接到设备后面板上的接地点。然后将地线的另一端连接到地面。

### 3 连接电源

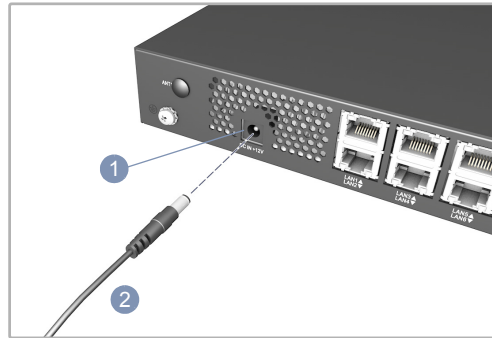

1. 将交流 / 直流电源适配器连接到设备上的直流插孔。
2. 将交流 / 直流电源适配器连接到外部交流电源。

### 4 验证设备已开机

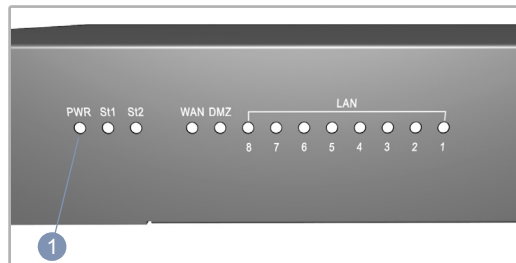

1. 通过检查电源 LED 验证设备已开机。正常操作时，电源 LED 应亮起绿色。

### 5 连接网线

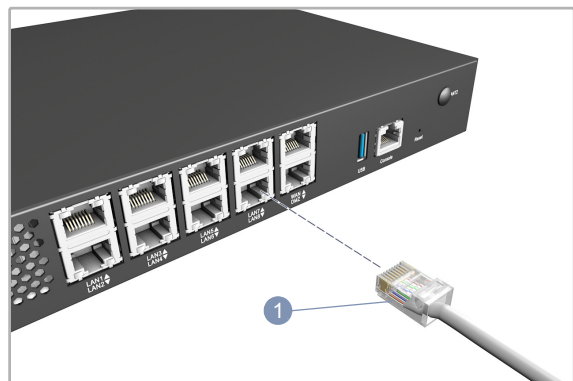

1. 对于 RJ-45 端口，请连接 100-ohm Category 5、5e 或更好的双绞线。

1. 建立连接后，检查端口状态 LED，确保连接正常。

- 绿色 — 1 Gbps 模式
- 琥珀色 — 10/100 Mbps 模式

## 6 连接到控制台端口

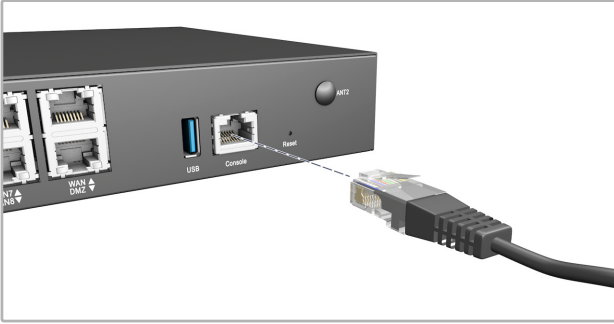

1. 使用附带的控制台线缆将 PC 连接到串行控制台端口。

2. 对 PC 的串行端口做以下配置：

- **115200 bps**
- **8 个字符**
- **无奇偶校验**
- **一个停止位**
- **8 个数字位**
- **无流控制**

3. 使用默认设置登录 Ubuntu 系统：

- 用户名 **“root”**
- 密码 **“accton”**

## SAF51003I 规格

规格	紧凑型台式
尺寸 (宽 x 深 x 高):	300 x 200 x 38.5 mm (11.81 x 7.87 x 1.52 英寸)
重量	1.58 kg (3.48 磅)
CPU	用于 Communications C3000 系列的 SoC, Intel® Atom™ 处理器 (FCBGA, 14nm), 支持 2-4 核 2.2 GHz (加速模式 2.4 GHz)
内存	管座: 2 x 260 针 DDR4 SODIMM 插槽 Type: DDR4 1866/2133/2400 MHz ECC (最大 64 GB)
本地存储	1 x 2.5" 500GB HDD 1 x M.2 SATAIII SSD, 支持 2242/2280 类型
I/O 接口	1 x USB 3.0 类型 A 1 x RJ-45 串行控制台 1 x 硬件重置按钮
网络接口	1 x RJ-45 GbE (DMZ) 1 x RJ-45 port (WAN) 8 x RJ-45 GbE (LAN)
扩充	Type: 1 x Mini PCIe 信号: PCIe x1 和 USB 2.0
加速器	先进技术: Intel® VT-x、Intel® VT-d、SR-IOV、VMDq、QuickAssist、PECI over SMBUS、eSPI、NC-SI、内核与内存 RAPL、内存 OLTT 和 CLTT
电源适配器	输入: 交流 110 到 240 @ 50/60 Hz 输出: 12 VDC, 5.0 A, 60 W
系统散热	2x PWM 风扇, 支持智能风扇
温度	工作时: 0 °C 到 40 °C (32 °F 到 104 °F) 存储: -20 °C 到 70 °C (-4 °F 到 158 °F)
湿度	工作时: 20% 到 90% (无冷凝) 存放时: 5% 到 90% (无冷凝)
认证	CE FCC RoHS 2.0